

SIGMADENT

CATALOGUE

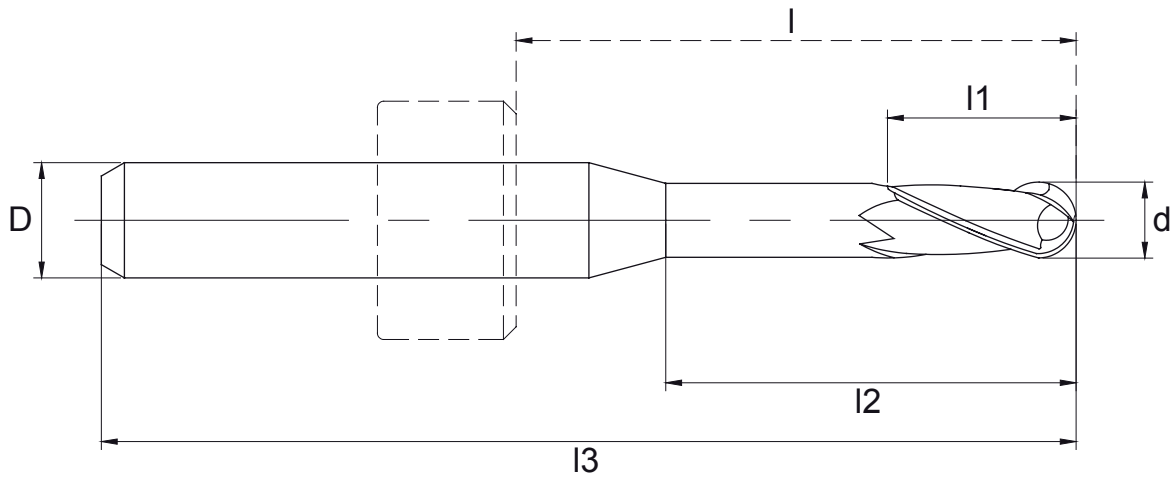



Diamond Carbon (DC)

- D: Shank Diameter (mm)
- d: Flute Diameter (mm)
- l1: Flute Length (mm)
- l2: Effective Length (mm)
- l3: Overall Length (mm)
- l: Ring Position (mm)



Chrome-Nitride (CrN)

Our solid carbide end mills, compatible with mainstream CAD/CAM machines or systems, are good choice for trimming, zirconia porcelain, titanium, cobalt-chromium alloy, PMMA and etc.

Depending on the trimmed material, we recommend different coatings. While DCL and DC targeted at metals, and CrN coating is especially suitable for PMMA. The DC coating end mills can reach an 8 to 10 times of the service life. Customization services are offered upon request.

CAD/CAM MILLING BURS



IMES-ICORE

dl						CrN	DC	Order No.	
	1	I2	I3	D	I				
0.6	2.0	10	48	3	25.8	5301010	5321010	5391010	
1.0	5.0	14	48	3	25.8	5301105	5321105	5391105	
2.5	8.0	20	48	3	25.8	5301207	5321207	5391207	

* compatible with "Imes-Icore 240/250"



dl						CrN	DC	Order No.	
	1	I2	I3	D	I				
0.6	2.5	12	53	6	30	5304001	5324001	5394001	
1.0	6.0	14	53	6	30	5304104	5324104	5394104	
2.5	10.0	20	53	6	30	5304204	5324204	5394204	

* compatible with "Imes-Icore 350/550/750"



ROLAND

dl						CrN	DC	Order No.	
	1	I2	I3	D	I				
0.3	1.5	6	50	4	/	5303009	5323009		
0.6	1.5	6	50	4		5303001	5323001	5393001	
1.0	3.5	16	50	4		5303103	5323103	5393103	
2.0	3.5	16	50	4		5303201	5323201	5393201	
1.0	3.5	20	50	4	/	5303104	5323104	5393104	
2.0	5.0	25	52	4		5303202	5323202	5393202	



SIRONA

dl						CrN	DC	Order No.	
	1	I2	I3	D	I				
0.5	1.0	5	42	3	23.5	5301012	5321012	5391012	
1.0	3.5	18	43	3	24.5	5301125	5321125	5391125	
2.5	5.0	25	43	3	25.5	5301222	5321222	5391222	

* compatible with "Sirona X5"



VHF

dl	1	l2	l3	D	l	Order No.		
						CrN	DC	
0.6	2.0	7	35	3	24	5301002	5321002	
1.0	3.5	16	35	3	24	5301101	5321101	5391101
2.0	3.5	16	35	3	24	5301201	5321201	5391201

* compatible with "VHF K1/K4"



dl	1	l2	l3	D	l	Order No.		
						CrN	DC	
0.3	1.2	13	40	3	26.5	5301015	5321015	
0.6	2.0	7	40	3	26.5	5301009	5321009	5391009
1.0	3.5	16	40	3	26.5	5301116	5321116	5391116
2.0	3.5	16	40	3	26.5	5301209	5321209	5391209

* compatible with "VHF K5"



ZIRKON ZAHN

dl	1	l2	l3	D	l	Order No.		
						CrN	DC	
0.5	1.5	6	57	3		5301017	5321017	5391017
1.0	6.0	12	57	3		5301110	5321110	5391110
2.0	10.0	18	57	3		5301215	5321215	5391215

* compatible with "Zirkon Zahn M5"



dl	1	l2	l3	D	l	Order No.		
						CrN	DC	
0.5	3.0	20	50	6		5304003		5394003
1.0	6.0	12	50	6		5304108		5394108
2.0	10.0	18	50	6		5304209		5394209
1.0	6.5	20	50	6			5324109	
2.0	8.0	17	50	6			5324210	

* compatible with "Zirkon Zahn M1"

CAD/CAM MILLING BURS

WIELAND



dl	1	l2	l3	D	l	CrN DC		
						Order No.		
0.7	2.0	7	35	3	24	5301001	5321001	
1.0	3.5	16	35	3	24	5301101	5321101	5391101
2.5	3.5	20	35	3	24	5301205	5321205	5391205

* compatible with "WIELAND MINI"



dl	1	l2	l3	D	l	CrN DC		
						Order No.		
0.7	2.0	7	40	3	26.5	5301007	5321007	5391007
1.0	3.5	16	40	3	26.5	5301116	5321116	5391116
2.5	5.0	20	40	3	26.5	5301212	5321212	5391212

* compatible with "WIELAND S1"

YENA



dl	1	l2	l3	D	l	CrN DC		
						Order No.		
0.61	.5	10	45	4		5303010	5323010	5393010
1.0	3.5	16	45	4	21.25	5303105	5323105	5393105
2.0	3.5	16	45	4	21.25	5303205	5323205	5393205

CERCON



dl	1	l2	l3	D	l	CrN		
						Order No.		
0.52	.0	10	55	3.5		5306001		
1.0	8.0	20	55	3.5		5306101		
2.0	10.0	20	55	3.5		5306201		
1.0	8.0	25	50	3.5			5326102	
2.0	10.0	25	50	3.5			5326202	

CAD/CAM MILLING BURS



RK

dl	1	l2	l3	D	I	DC	
						Order No.	
1.0	3.5	18	47	3			5391126
2.0	3.5	25	47	3			5391237



KAVO

dl	1	l2	l3	D	I	DC	
						Order No.	
1.0	2.0	16.0	53	6		5304130	5394130
2.0	2.0	19.5	53	6		5304222	5394222



AMANN GIRBACH

dl	1	l2	l3	D	I	CrN		DC
						Order No.		
0.30	.6	16	47	3	20.5	5301021	5321021	
0.6	2.0	13	47	3	20.5	5301004	5321004	
1.0	3.5	16	47	3	20.5	5301104	5321104	5391104
2.5	3.5	16	47	3	20.5	5301206	5321206	5391206



DENTIUM

dl	1	l2	l3	D	I	CrN		DC
						Order No.		
1.0	3.5	16	50	6		5304102	5324102	5394102
2.0	3.5	16	50	6		5304202	5324202	5394202